

ISSUE DATE:

Dec 24, 2012

REVISIONS:

NORTH CITIES UPC EXPANSION

RON HOBBS ARCHITECTS

614 WEST MAIN STREET, SUITE 200  
GARLAND, TEXAS 75040  
PHONE: 972-494-0174 www.ronhobbsarchitects.net

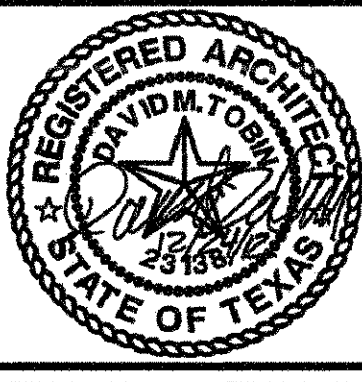

JOB NUMBER

1107

SHEET NUMBER

FIRST FLOOR PLAN

A101

GARLAND, TEXAS

WALL LEGEND

- 1 KING SIZE BRICK ON 4" CMU, 4" STEEL STUDS @ 16" O.C., 5/8" GYP BOARD ON INTERIOR
- 1 1/2" EPS ON 1/2" SHEATHING, 6" STEEL STUDS @ 16" O.C., 5/8" GYP BOARD ON INTERIOR
- 5/8" GYP BOARD EACH SIDE ON 3 5/8" METAL STUDS @ 16" O.C. (TYPICAL U.N.O.)
- 5/8" GYP BOARD EACH SIDE ON METAL STUDS @ 16" O.C. WITH ACOUSTICAL BATT INSULATION

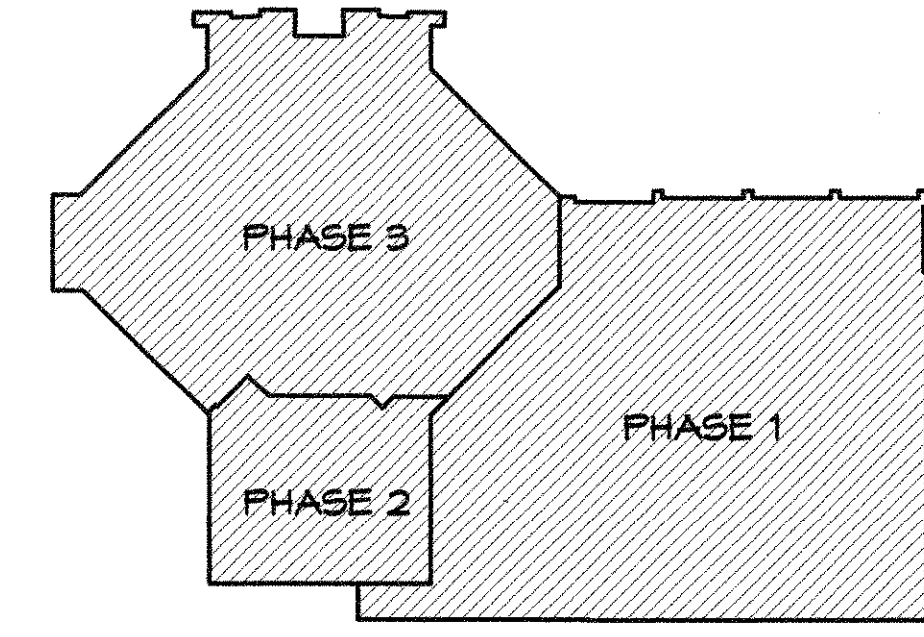

PHASING PLAN NOT TO SCALE

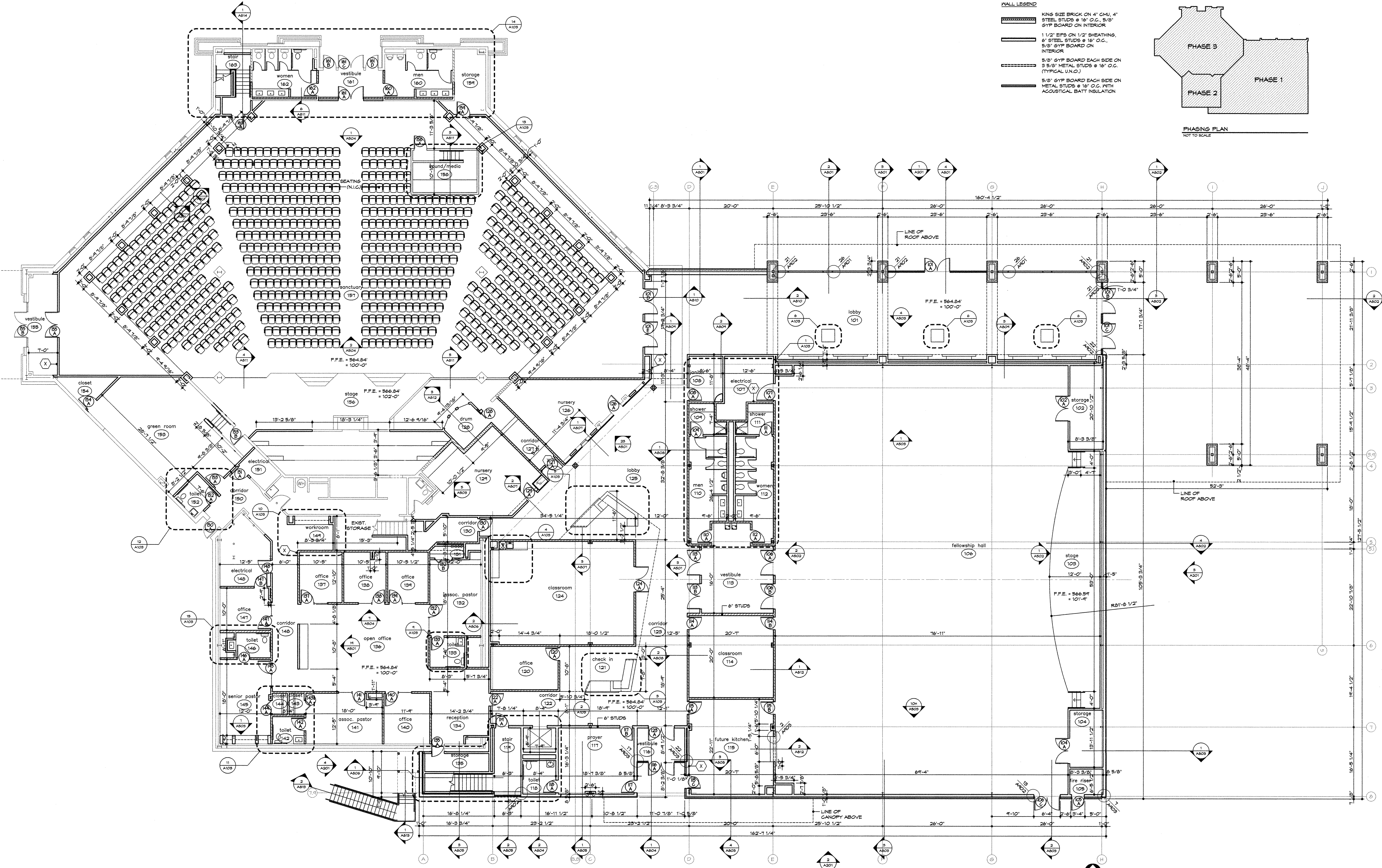

1 FIRST FLOOR PLAN SCALE: 1/8" = 1'-0"



PLAN NORTH